

Progress GFK

Progress GFK

Material: Polyamid glasfaserverstärkt  
 Farbe: Schwarz RAL 9005  
 Dichtung: TPE  
 Einsatztemperatur: -20°C / +100°C  
 Schutzart: IP 68

Material: Polyamide glass fiber reinforced  
 Colour: Black RAL 9005  
 Seal: TPE  
 Temperature range: -20°C / +100°C  
 Protection class: IP 68

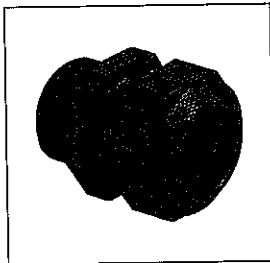
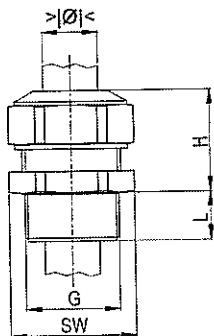

### Einteiliger Dichtungseinsatz Anschlussgewinde Pg

### One-piece sealing insert Entry thread Pg

Art.-Nr.	G	Øk mm	mm	H mm	L mm	
1540.07.050	Pg 7	3.5-5.0	17	22	12	50
1540.07.065	Pg 7	5.0-6.5	17	22	12	50
1540.07.080	Pg 7	6.5-8.0	17	22	12	50
1540.09.060	Pg 9	4.5-6.0	21	26	12	50
1540.09.080	Pg 9	6.0-8.0	21	26	12	50
1540.09.105	Pg 9	8.0-10.5	21	26	12	50
1540.11.055	Pg 11	4.0-5.5	24	28	12	50
1540.11.085	Pg 11	5.5-8.5	24	28	12	50
1540.11.120	Pg 11	8.5-12.0	24	28	12	50
1540.13.080	Pg 13	6.0-8.0	27	28	13	50
1540.13.110	Pg 13	8.0-11.0	27	28	13	50
1540.13.150	Pg 13	11.0-15.0	27	28	13	50
1540.16.080	Pg 16	6.0-8.0	27	28	13	50
1540.16.110	Pg 16	8.0-11.0	27	28	13	50
1540.16.150	Pg 16	11.0-15.0	27	28	13	50
1540.21.125	Pg 21	9.5-12.5	34	33	13	25
1540.21.160	Pg 21	12.5-16.0	34	33	13	25
1540.21.205	Pg 21	16.0-20.5	34	33	13	25
1540.29.190	Pg 29	16.0-19.0	41	36	13	25
1540.29.230	Pg 29	19.0-23.0	41	36	13	25
1540.29.275	Pg 29	23.0-27.5	41	36	13	25
1540.36.260	Pg 36	21.5-26.0	55	42	16	10
1540.36.305	Pg 36	26.0-30.5	55	42	16	10
1540.36.350	Pg 36	30.5-35.0	55	42	16	10
1540.42.330	Pg 42	29.0-33.0	60	42	16	10
1540.42.370	Pg 42	33.0-37.0	60	42	16	10
1540.42.420	Pg 42	37.0-42.0	60	42	16	10
1540.48.370	Pg 48	32.0-37.0	70	46	16	5
1540.48.430	Pg 48	37.0-43.0	70	46	16	5
1540.48.490	Pg 48	43.0-49.0	70	46	16	5

### Zweiteiliger Dichtungseinsatz Anschlussgewinde Pg

### Two-piece sealing insert Entry thread Pg

Art.-Nr.	G	Øk mm	mm	H mm	L mm	
1540.09	Pg 9	6.0-10.5	21	26	12	50
1540.11	Pg 11	5.5-12.0	24	28	12	50
1540.13	Pg 13	8.0-15.0	27	28	13	50
1540.16	Pg 16	8.0-15.0	27	28	13	50
1540.21	Pg 21	12.5-20.5	34	33	13	25
1540.29	Pg 29	19.0-27.5	41	36	13	25
1540.36	Pg 36	26.0-35.0	55	42	16	10
1540.42	Pg 42	33.0-42.0	60	42	16	10
1540.48	Pg 48	37.0-49.0	70	46	16	5